

REMEMBER TO ORDER NUTS & BOLTS

ANGLE UPRIGHTS £ each

Pierced on a 3" pitch. Finished to Shelving Angle Specification. PLUS hot dipped galvanised for arduous conditions.

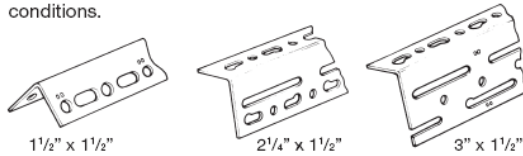

CONTENTS/ FINISH	CODE	£ EACH	CODE	£ PER CUT LENGTH/FT
1 1/2" x 1 1/2" 14 swg steel. Packed without accessories				
10' Painted	E15010GX	18.27	E150GX[FT]	2.24
12' Painted	E15012GX	22.24		
10' Galv.	E15010GS	24.35	E150GS[FT]	2.91
2 1/4" x 1 1/2" 14 swg steel. Packed without accessories				
10' Painted	E22510GX	23.04	E225GX[FT]	2.55
12' Painted	E22512GX	27.68		
10' Galv.	E22510GS	29.54	E225GS[FT]	3.18
3" x 1 1/2" 12 swg steel. Packed without accessories				
12'6" Painted	E300125GX	40.79	E300GX[FT]	3.63
12'6" Galv.	E300125GS	56.08	E300GS[FT]	4.19

SLOTTED STRIP £ each

1 3/8" x 12 swg steel for use with all Angle sections.

CONTENTS/ FINISH	CODE	£ EACH
6' Painted	SFSGX	7.75
6' Galvanised	SFSGS	10.33

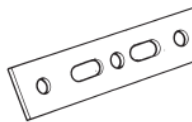

NUTS & BOLTS £ each

Zinc passivated, lacquered, for use with CONSTRUCTION ANGLE ONLY

SIZE	CODE	£ EACH
5/16 x 5/8	NB56HH58ZG	0.24
5/16 x 15/16	NB56HH10ZG	0.29

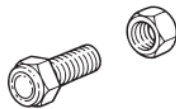

Shaded items available on 5-8 working day delivery

Shaded items subject to manufacture lead time

Unshaded items on extended manufacture lead time



TENSION PLATES £ each

Tension plates ensure structural rigidity. For use with 1 1/2" CONSTRUCTION ANGLE ONLY. One side painted Light Grey, reverse Graphite Grey.



FINISH	CODE	£ EACH
Painted	ETPGXGW	0.40
Galvanised	ETPGT	0.41

HD TENSION PLATES £ each

Tension plates ensure structural rigidity. For use with 2 1/4" and 3" CONSTRUCTION ANGLE ONLY. One side painted Light Grey, reverse Graphite Grey.

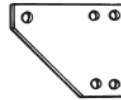

FINISH	CODE	£ EACH
Painted	UCPHDGX	2.26
Galvanised	UCPHDGT	3.07

CASTORS £ each

2 1/2" castors supplied with nylon or steel wheels with a maximum load per wheel of 120lbs, and 160lbs respectively. 5" rubber wheel castor, as above, 130lbs max. wheel loading. All castors fitted with triangular fixing plate and thread guard.

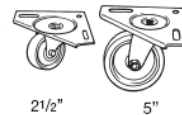

CONTENTS	FIXED		SWIVEL	
	CODE	£ EACH	CODE	£ EACH
2 1/2" Nylon	CBF	10.07	CBS	12.47
2 1/2" Steel	CCF	12.47	CCS	15.12
5" Rubber	CEF	24.21	CES	25.10

PORTABLE ANGLE CUTTER £ each

Single stroke cutter for use with all angles.

CONTENTS	CODE	£ EACH
Cutter	C	340.47
Replacement Blades	CB	119.74



STEEL PLANKING £ each



FINISH	CODE	£ EACH
6' x 9"	LD60GT	59.35
4'6" x 9"	LD45GT	44.19
Cleats	LDRC	1.07
Splices	LDS	2.78